

Pot Holding Systems with Female Thread

The pot holding systems that have a female thread are ideal for a range of different holding applications. The structure consists of a magnet encased in a steel cup with an internally threaded stud. This design makes them robust, versatile and also ensures an additional magnetic hold compared with the magnet being used independently.

These pots use a Sintered Ferrite magnet and are rated to a maximum working temperature of +120°C. Plated hooks are available for M4 threaded sizes.

Ferrite Pot with Female Thread						
Dimensions (mm)						
Part Number	ØD	H	L	G	Ød	Holding Force (Kg)
SFSP 00180	10	4.5	11.5	M3	6	0.4
SFSP 00181	13	4.5	11.5	M3	6	0.9
SFSP 00113	16	4.5	11.5	M3	6	1.8
SFSP 00182	20	6	13	M3	6	2.8
SFSP 01874	25	7	15	M4	8	3.0
SFSP 00114	25	7	15	M4	8	4.0
SFSP 00183	32	7	15	M4	8	8.0
SFSP 00184	36	8	15	M4	8	10.0
SFSP 00185	40	8	18	M5	10	13.0
SFSP 00186	47	9	19	M6	12	16.0
SFSP 00115	50	10	22	M6	12	24.0
SFSP 00187	57	11	21	M6	12	28.0
SFSP 00188	63	14	30	M8	15	32.0
SFSP 00189	80	18	34	M10	16	60.0

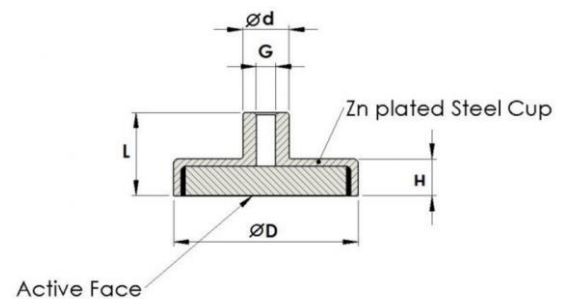

Please note:

Holding Forces are based upon direct contact with a thick, clean mild steel surface. Holding Forces will be reduced with heavily painted or corroded surfaces.

Before selecting a choice of holding system please consider the working environment of your application.

Hooks available for M4 threaded holes

Magnet Sales & Service Limited
Unit 31 Blackworth Industrial Estate,
Highworth, Wilts SN6 7NA UK

Tel: +44 (0)1793 862100
Fax: +44 (0)17993 862101
sales@magnetsales.co.uk
www.magnetsales.co.uk



Certificate No 2346